



THE THOMAS DEACON ACADEMY
UNIVERSITY COLLEGE DUBLIN
SALFORD UNIVERSITY
THE ACADEMY OF ST. FRANCIS OF ASSISI

PARTITIONS & CEILINGS

DOORS PANELS & JOINERY

FURNITURE & STORAGE

ARCHITECTURAL GLASS

SIGNAGE & GRAPHICS

komfort.com



THE PARTITION
PROJECT
DELIVERY TEAM

Architects: Foster & Partners

Main Contractor: Laing O'Rourke

Specialist Sub Contractor: Stortford Interiors

Manufacturer: Komfort Workspace plc



THE THOMAS DEACON ACADEMY

Laing O'Rourke commissioned the Komfort Registered Contractor (KRC) Stortford Interiors to install the Komfort PolarTec glazed partition and door module system at the much acclaimed Thomas Deacon Academy, Peterborough. Over 600 linear metres of the system was used to create classrooms, laboratories, dance and music studios in a combination of straight and faceted elevations.

From initial discussions with Laings and Stortford relating to the high performance specification set by Foster and Partners, the Komfort team designed, tested, manufactured and delivered the PolarTec system within 12 weeks.

Safety, of course, is paramount in buildings used by children and students. PolarTec's high level of structural, fire and acoustic performance has been achieved whilst maintaining the system's ability to be demountable and relocatable.

Such flexibility of use will cater for emerging trends in education over the life of the building.



Above:
The Komfort Signage & Graphics division is able to print and apply any digital image to glazed screen manifestations, fabrics and wall vinyl

Left:
Both faceted and straight PolarTec glazed partitioning are used to create stunning modern classroom environments and workspaces



Half-hour glazed fire door in the PolarTec aluminium door frame



Half-hour fire rated timber door modules

Performance Data - PolarTec

Fire to BS 476: Part 22 - 30 mins integrity and insulation

Sound to BS EN ISO 140-3 - 46dB (Rw)

Strength to BS 5234 - Severe

Strength to BS 6180/6399 - 1500N/Linear metre at 1200mm above FFL complete with attendant UDL and point load requirements

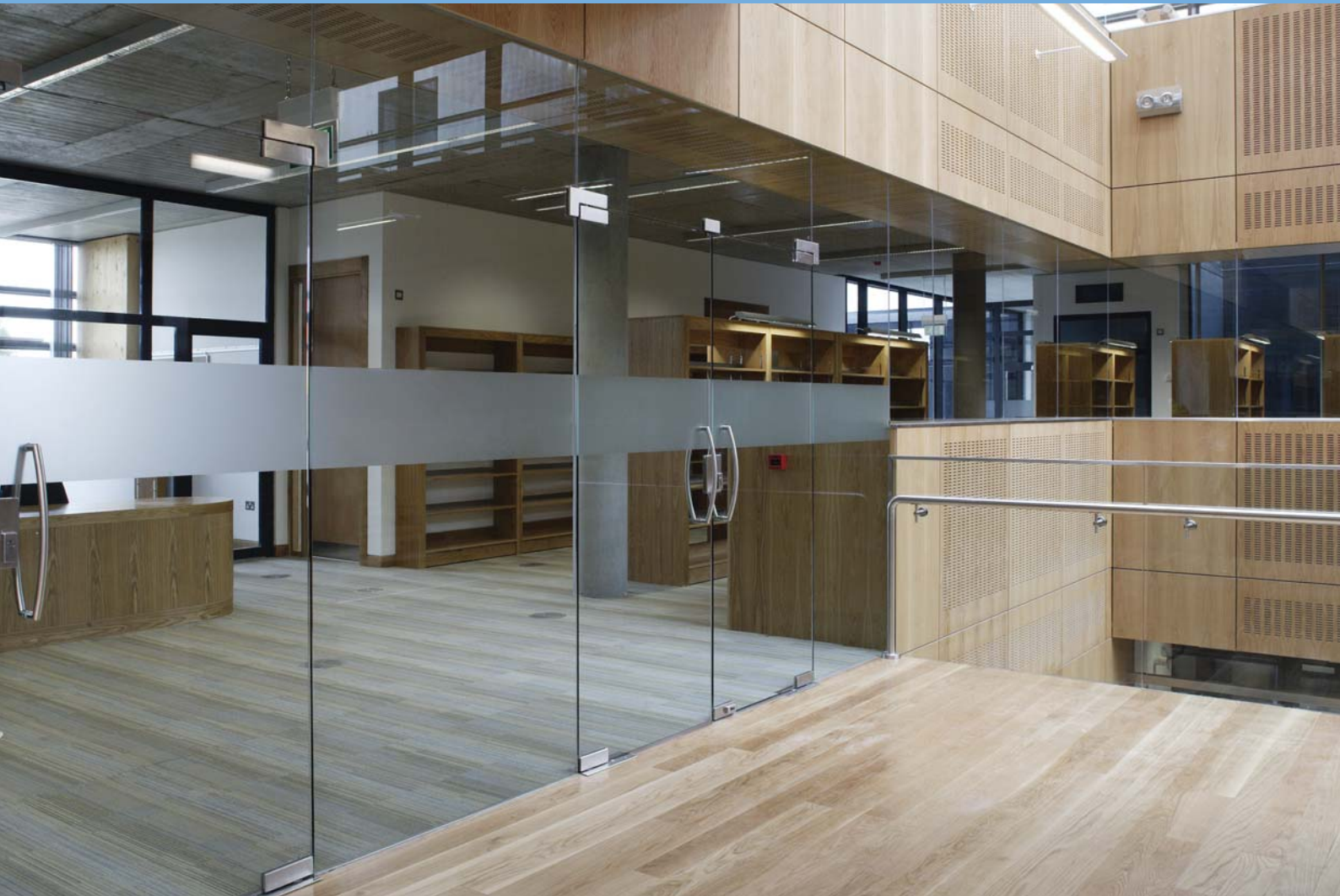

Products from all five divisions of Komfort Workspace were utilised in these stunning designs for Dublin and Salford Universities

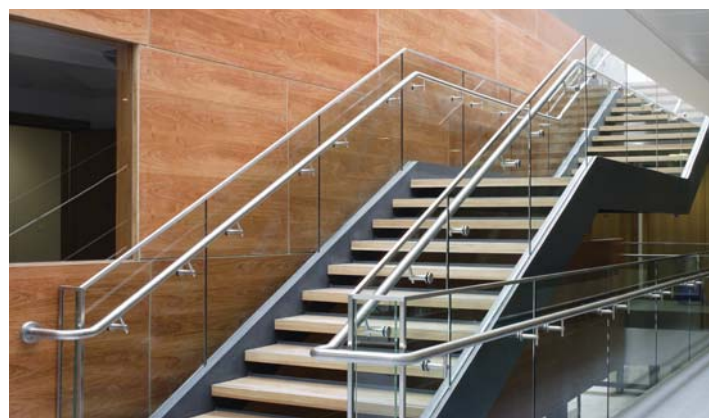



PARTITIONS & CEILINGS

DOORS PANELS & JOINERY

FURNITURE & STORAGE

ARCHITECTURAL GLASS

SIGNAGE & GRAPHICS





Corridor doors and doorsets and student corridor lockers



Student changing room lockers



Student storage units



Tables and benches in the student canteen

THE ACADEMY OF ST. FRANCIS OF ASSISI

Capita Percy Thomas' Interiors team has worked in conjunction with the Komfort Education Environments division to provide interior design solutions that complement the structure of the building and help to deliver the Academy's environmental ethos through to the 'classroom' itself. The team has also worked with the client and user group to establish coherent space plans that meet their educational needs and DfES guidelines.

This in turn has influenced the procurement of all furniture to the Academy and allowed CPTI to work closely with Komfort, introducing a contemporary feel to the classrooms and key social spaces. The key aspiration, for the internal spaces, was to reflect social environments that students have become accustomed to in their everyday lives - being familiar and comfortable (e.g. the cyber café, the coffee bar and the shopping centre.) The flexibility and adaptability brought to the spaces through the furniture and fittings bring a dynamic and modern approach to the school environment and teaching methods.

Deborah Rogers, Interior Design Team Leader, Capita Percy Thomas



Komfort Education Environments

Unit 2, Intermezzo Drive
Stourton Link, Leeds LS10 1RU

Tel 0113 395 6576

Fax 0113 395 6566

Email education@komfort.com

komfort.com

